

GRAPHIC SCALE



SURVEYOR'S NOTES:

- (1) SURVEYOR HAS MADE NO INVESTIGATION OR INDEPENDENT SEARCH FOR EASEMENTS OF RECORD, ENCUMBRANCES, RESTRICTIVE COVENANTS, OWNERSHIP TITLE EVIDENCE, OR ANY OTHER FACTS WHICH AN ACCURATE AND CURRENT TITLE SEARCH MAY DISCLOSE.
  - (2) SINCE THE DATE OF THIS SURVEY, CONDITIONS BEYOND THE KNOWLEDGE OR CONTROL OF LARRY WALKER LAND SURVEYING, INC. MAY HAVE ALTERED THE VALIDITY AND CIRCUMSTANCES SHOWN OR NOTED HEREIN.
  - (3) DECLARATION IS MADE TO THE ORIGINAL PURCHASER OF THIS SURVEY. IT IS NOT TRANSFERABLE TO ADDITIONAL INSTITUTIONS OR SUBSEQUENT OWNERS.
  - (4) SURVEY IS VALID ONLY IF PRINT HAS THE ORIGINAL SEAL AND SIGNATURE (IN RED INK) OF THE SURVEYOR PRESENT.
  - (5) ALL BUILDINGS, SURFACE AND SUBSURFACE IMPROVEMENTS ON AND ADJACENT TO THE SITE ARE NOT NECESSARILY SHOWN.
  - (6) ONLY ACTS OF POSSESSION, IF ANY, THAT ARE VISIBLE FROM CASUAL INSPECTION OF THE PROPERTY ARE SHOWN HEREIN. NO WARRANTY OR GUARANTEE IS IMPLIED AS TO THE EXISTENCE OF ACTS OF POSSESSION BY ADJOINERS TO THE LANDS SHOWN AND DESCRIBED HEREIN.
  - (7) THE PROPERTY LINES SHOWN ON THE SURVEY PLAT ARE BASED UPON OLD ESTABLISHED CORNERS AND AGREED CORNERS BETWEEN ADJOINING LAND OWNERS AND MAY NOT BE THE LINES OF THE ALIQUOT PARTS OF THE SECTION AND CARRY NO WARRANTY THAT THEY ARE THE LINES OF THE ALIQUOT PARTS OF THE SECTION.
  - (8) DATE FIELD SURVEY COMPLETED ( 03/08/23 )
  - (9) DATE DRAWING COMPLETED ( 03/09/23 )
  - (10) ( ) RECORDED BEARINGS, ANGLES OR DISTANCES.
  - (11) POB POINT OF BEGINNING
  - (12) POC POINT OF COMMENCEMENT
  - (13) TYPE OF SURVEY: PROPERTY BOUNDARY SURVEY
- I HEREBY STATE THAT ALL PARTS OF THIS SURVEY AND DRAWING HAVE BEEN COMPLETED IN ACCORDANCE WITH THE CURRENT REQUIREMENTS OF THE STANDARDS OF PRACTICE FOR SURVEYING IN THE STATE OF ALABAMA TO THE BEST OF MY KNOWLEDGE, INFORMATION AND BELIEF.

STATE OF ALABAMA:  
COUNTY OF ST. CLAIR:

LEGAL DESCRIPTION:

COMMENCE AT A 1/2" REBAR MARKING THE SW CORNER OF THE SW1/4-NW1/4 IN SECTION 7, T-14-S, R-6-E, THENCE S89°54'05"E 152.76' ALONG THE SOUTH LINE OF SAID FORTY TO A 1/2" PIPE ON THE WESTERLY R/W OF LAUNCH DRIVE (100' R/W); THENCE LEAVING SAID FORTY LINE AND ALONG SAID R/W N08°03'34"W 260.50' TO A 1/2" REBAR CAPED(BURGETT CA0078), SAID POINT BEING THE POINT OF BEGINNING; THENCE LEAVING SAID R/W S79°05'55"W 366.80' TO A 1/2" REBAR CAPED(BURGETT CA0078), THENCE N37°12'15"W 76.87' TO A 1/2" REBAR CAPED(BURGETT CA0078), THENCE N66°49'15"W 190.40' TO A 1/2" REBAR CAPED(BURGETT CA0078), THENCE S51°42'08"W 116.37' TO A 1/2" REBAR CAPED(BURGETT CA0078), THENCE N36°28'53"W 273.52' TO A 1/2" REBAR CAPED(BURGETT CA0078), THENCE N06°41'16"W 425.03' TO A 1/2" REBAR CAPED(BURGETT CA0078), THENCE N84°04'01"E 74.19' TO A 1/2" REBAR CAPED(BURGETT CA0078), THENCE N43°03'23"W 280.03' TO A 1/2" REBAR CAPED(BURGETT CA0078), THENCE N10°45'51"E 107.97' TO A 1/2" REBAR CAPED(BURGETT CA0078), THENCE N49°15'52"E 150.65' TO A 1/2" REBAR CAPED(BURGETT CA0078), THENCE N10°45'51"E 107.97' TO A 1/2" REBAR CAPED(BURGETT CA0078), THENCE S47°00'40"E 704.38' TO A 1/2" REBAR CAPED(BURGETT CA0078), THENCE S83°41'42"W 175.54' TO A 1/2" REBAR CAPED(BURGETT CA0078), THENCE S13°52'25"E 213.35' TO A 1/2" REBAR CAPED(BURGETT CA0078), THENCE S33°30'39"E 90.73' TO A 1/2" REBAR CAPED(BURGETT CA0078), THENCE S53°42'39"E 104.64' TO A 1/2" REBAR CAPED(BURGETT CA0078), THENCE S53°42'39"E 104.64' TO A 1/2" REBAR CAPED(BURGETT CA0078), THENCE S53°42'40"E 101.58' TO A 1/2" REBAR CAPED(BURGETT CA0078), THENCE S32°25'50"E 55.17' TO A POINT ON THE APPROXIMATE 509' CONTIUR OF LAKE NEELY HENRY; THENCE ALONG SAID APPROXIMATE 509' CONTIUR A CHORD BEARING AND DISTANCE OF S18°20'47"E 97.98' TO A 1/2" REBAR CAPED(BURGETT CA0078), THENCE LEAVING SAID APPROXIMATE 509' CONTIUR S83°41'42"W 175.54' TO A 1/2" REBAR CAPED(BURGETT CA0078), THENCE S13°52'25"E 213.35' TO A 1/2" REBAR CAPED(BURGETT CA0078), THENCE S33°30'39"E 90.73' TO A 1/2" REBAR CAPED(BURGETT CA0078), THENCE S53°42'39"E 104.64' TO A 1/2" REBAR CAPED(BURGETT CA0078), THENCE S53°42'40"E 101.58' TO A 1/2" REBAR CAPED(BURGETT CA0078), THENCE S32°25'50"E 55.17' TO A 1/2" REBAR CAPED(BURGETT CA0078), THENCE S84°14'33"E 34.86' TO A 1/2" REBAR CAPED(BURGETT CA0078), THENCE S84°14'33"E 34.86' TO A 1/2" REBAR CAPED(BURGETT CA0078), THENCE S79°05'55"W 366.80' TO A 1/2" REBAR CAPED(BURGETT CA0078), THENCE N08°03'34"W 260.50' TO THE POINT OF BEGINNING, CONTAINING 15.71 ACRES MORE OR LESS.

15.71  
ACRES +/-

CURVE TABLE			
CURVE	CHORD LENGTH	CHORD BEARING	RADIUS
C1	139.73'	S13°24'52"E	1493.02'

LINE TABLE		
LINE	LENGTH	BEARING
L1	65.03'	N32°31'48"W
L2	55.17'	S32°25'50"E
L3	34.86'	S84°14'33"E

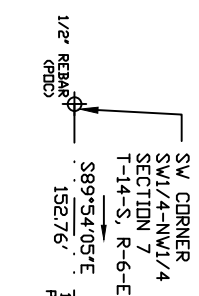

LAUNCH DRIVE (100' R/W)

